

TRAFFIC REGULATION ORDER (TRO) CONSULTATION

CMS1405MM – Penland Road, Haywards Heath

24/8/17 – 14/9/17

Contents

Notice	Page 2
Statement of Reasons	Page 3
Draft Order	Page 6
Plans (existing & proposed)	Pages 8-21

West Sussex County Council
(Mid Sussex District) (Parking Places & Traffic Regulation) (Consolidation No.2)
Order 2006)

(Haywards Heath: Western Parking Review) Order 2017

NOTICE is hereby given that West Sussex County Council proposes to make a permanent Traffic Regulation Order under the provisions of the Road Traffic Regulation Act 1984, the effect of which will be to introduce or amend waiting restrictions in the following roads in Haywards Heath:

Balcombe Road, Barnmead, Burrell Road, Fairfield Way, Harlands Road, Mill Green Road, Oakhurst Lane, Orchard Close, Orchard Way, Pasture Hill Road, Penland Close, Penland Road, Queens Road, The Spinney, Sugworth Close, Sydney Road, Turners Mill Road.

Full details of the proposals in this notice can be viewed on our website at www.westsussex.gov.uk. The website includes a response form for any comments or objections.

The documents may also be inspected at County Hall Chichester, during normal office hours, and at Haywards Heath Library, 34 Boltro Road, Haywards Heath during normal library opening hours.

Any comments or objections about the proposal must be received before 14 September 2017. These may be submitted via the response form on the website mentioned above, by e-mail to tro.team@westsussex.gov.uk or in writing to TRO Team, West Sussex County Council, The Grange, Tower Street Chichester, PO19 1RH. For legal reasons, only correspondence including a full name and address will be considered. Please quote reference CMS1405-MM in all correspondence.

Dated this 24th day of August 2017.
Director of Law & Assurance, County Hall, Chichester.

West Sussex County Council
(Mid Sussex District) (Parking Places & Traffic Regulation) (Consolidation No.2)
Order 2006)

(Haywards Heath: Western Parking Review) Order 2017

STATEMENT OF REASONS
FOR PROPOSING TO MAKE THE ORDER

West Sussex County Council proposes to make a permanent Traffic Regulation Order under the provisions of the Road Traffic Regulation Act 1984, the effect of which will be to introduce or amend waiting restrictions on roads in Haywards Heath as follows:

Balcombe Road:

Drawing No: TQ3225NES and TQ3225SEN

- Introduce double yellow line junction protection measures at its junctions with Oakhurst Lane, Fairfield Way and Penland Road,
- Extend length of current double yellow line junction measures at its junction with Barnmead,
- Introduce double yellow line junction protection measures at its junction with Oakhurst Lane.

Barnmead:

Drawing No: TQ3225SEN

- Remove a length of current single yellow line on southern side of the road to provide unrestricted parking.

Burrell Road:

Drawing No: TQ3224NEN and TQ3224NES

- Amend waiting restrictions outside Nuffield Hospital to accommodate a layby,
- Introduce double yellow lines and prohibit loading/unloading at any time on both sides of the road at the bend mid-way along Burrell Road,
- Extend length of double yellow line on eastern side of the road at its junction with Harlands Road and remove length of single yellow line on eastern side of the road to provide areas of unrestricted parking.

Fairfield Way:

Drawing No: TQ3225NES

- Introduce lengths of single yellow line prohibiting waiting 9am to 10am & 1pm to 2pm Mon-Fri,
- Introduce double yellow line junction protection measures at junctions with Orchard Way, Orchard Close and Balcombe Road.

Harlands Road:

Drawing No: TQ3224NEN

- Remove length of single yellow line on northern side of the road to provide unrestricted parking,
- Introduce double yellow line junction protection measures at junction with the cul-de-sac at 56-70 Harlands Road.

Mill Green Road:

Drawing No: TQ3324NWN

- Introduce restriction limiting waiting to 1 hour, no return within 1 hour 8am-6pm mon-Sat in layby on the eastern side of the road.

Oakhurst Lane:

Drawing No: TQ3225NES

- Introduce double yellow line junction protection measures at its junction with Balcombe Road,
- Introduce single yellow line prohibiting waiting 9am to 10am and 1pm to 2pm Mon-Fri on western side of the road.

Orchard Close:

Drawing No: TQ3225NES

- Introduce double yellow line junction protection measures at its junctions with Fairfield Way and the junction of the north/south section of Orchard Close.

Orchard Way:

Drawing No: TQ3225NES

- Introduce double yellow line junction protection measures at its junction with Fairfield Way.

Pasture Hill Road:

Drawing No: TQ3224NES

- Remove a length of waiting restrictions on southern side of the road to provide unrestricted parking,
- Introduce double yellow lines on southern side of the road to provide junction protection at the junction with Pasture Hill Road cul-de-sac.

Penland Close:

Drawing No: TQ3225SES

- Double Yellow Line junction protection measures at its junction with Penland Road.

Penland Road:

Drawing No: TQ3225NES, TQ3225SEN and TQ3225SES

- Introduce double yellow lines on lengths of road between Balcombe Road and The Spinney,
- Introduce lengths of single yellow lines prohibiting waiting 9am to 10am & 1pm to 2pm Mon-Fri on various lengths of the road,
- Introduce double yellow line junction protection measures at its junction with Sugworth Close,
- Introduce double yellow line junction protection measures at its junction with Penland Close,
- Remove lengths of current single yellow line restriction to provide unrestricted parking near its junction with Penland Close and Sugworth Close.

Queens Road:

Drawing No: TQ3324NWS

- Introduce parking bay with waiting limited to 1 hour, no return within 1 hour 8am-9pm Mon-Sat on northern side of the road near its junction with Mill Green Road.

The Spinney:

Drawing No: TQ3225NES and TQ3225SEN

- Introduce lengths of single yellow lines prohibiting waiting 9am to 10am & 1pm to 2pm Mon-Fri.

Sugworth Close:

Drawing No: TQ3225SEN

- Introduce double yellow line junction protection measures at its junction with Penland Road,
- Remove length of current single yellow line on eastern side of the road to provide unrestricted parking.

Sydney Road:

Drawing No. TQ3324NWS

- Introduce a restriction for waiting limited to 1 hour no return within 4 hours 8am to 6pm Mon-Sat in the layby on the north side of the road, immediately west of its junction with the commercial square roundabout.

Turners Mill Road:

Drawing No: TQ3224NEN and TQ3225SES

- Remove lengths of current single yellow line on the eastern side of the road to provide unrestricted parking.

The new Order is proposed to improve the amenities of the area through which the affected lengths of roads run and to facilitate the passage of traffic.

The attached drawings, listed above show the lengths of roads affected by the proposed Order.

Director of Law & Assurance

8 June 2017

CMS1405-MM

WEST SUSSEX COUNTY COUNCIL
((MID SUSSEX DISTRICT) (PARKING PLACES & TRAFFIC REGULATION)
(CONSOLIDATION NO.2) ORDER 2006)

(HAYWARDS HEATH: WESTERN PARKING REVIEW) ORDER 2017

West Sussex County Council in exercise of their powers under Sections 1 (1) 2 (1) and (2), 4 (2), 45, 46, 49 and 53 and Part IV of Schedule 9 of the Road Traffic Regulation Act 1984 ("the Act") as amended and of all other enabling powers and after consultation with the Chief Officer of Police in accordance with Part III of Schedule 9 to the Act hereby make the following Order: -

1. This Order shall come into operation on the ***** day of ***** 2011 and may be cited as "West Sussex County Council ((Mid Sussex District) (Parking Places & Traffic Regulation) (Consolidation No.2) Order 2006) (Haywards Heath: Western Parking Review) Order 2017".
2. The "West Sussex County Council (Mid Sussex District) (Parking Places & Traffic Regulation) (Consolidation No.2) Order 2006" is hereby amended by the replacement of the plans specified in the First Schedule to this Order, with the plans specified in the Second Schedule, attached hereto.
3. The "West Sussex County Council (Mid Sussex District) (Parking Places & Traffic Regulation) (Consolidation No.2) Order 2006" is hereby amended by the insertion of the plans specified in the Third Schedule, attached hereto.

FIRST SCHEDULE
Plans to be Replaced

TQ3224NEN (Issue Number 4)
TQ3224NES (Issue Number 3)
TQ3225SEN (Issue Number 3)
TQ3225SES (Issue Number 4)
TQ3324NWN (Issue Number 4)
TQ3324NWS (Issue Number 4)

SECOND SCHEDULE
Replacement Plans

TQ3224NEN (Issue Number 5)
TQ3224NES (Issue Number 4)
TQ3225SEN (Issue Number 4)
TQ3225SES (Issue Number 5)
TQ3324NWN (Issue Number 5)
TQ3324NWS (Issue Number 5)

THIRD SCHEDULE
Plans to be Inserted

TQ3225NES (Issue Number 1)

THE Common Seal of THE)
WEST SUSSEX COUNTY COUNCIL)
was hereto affixed the)
)
day of)
2017)
)
)
)
Authorised Signatory)
CMS1405-MM)

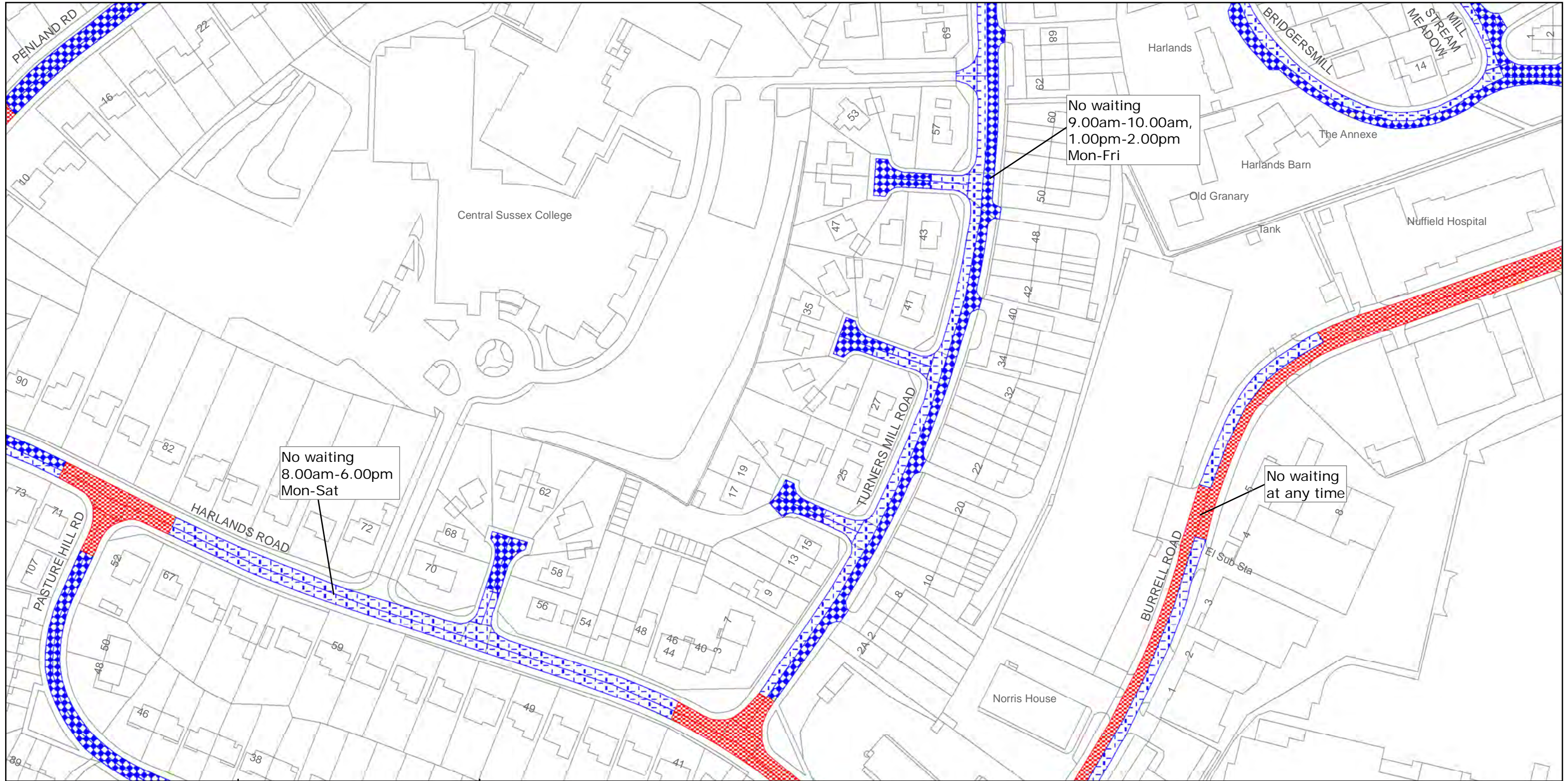

No waiting
8.00am-6.00pm
Mon-Sat

No waiting
9.00am-10.00am,
1.00pm-2.00pm
Mon-Fri

No waiting
at any time



West Sussex County Council
Highways & Transport
The Grange
Tower Street
Chichester
West Sussex
PO19 1RH

MID SUSSEX DISTRICT: HAYWARDS HEATH
WAITING RESTRICTIONS

TILE REF NO:
TQ3224NEN

SHEET ISSUE NO 4
SHEET ACTIVE FROM - 12/10/2015



SCALE:
1:1250
at A3 size

Reproduced from or based upon 2013 Ordnance Survey material with permission of the Controller of HMSO (c) Crown Copyright reserved.
Unauthorised reproduction infringes Crown copyright and may lead to prosecution or civil proceedings West Sussex County Council Licence No. 100023447

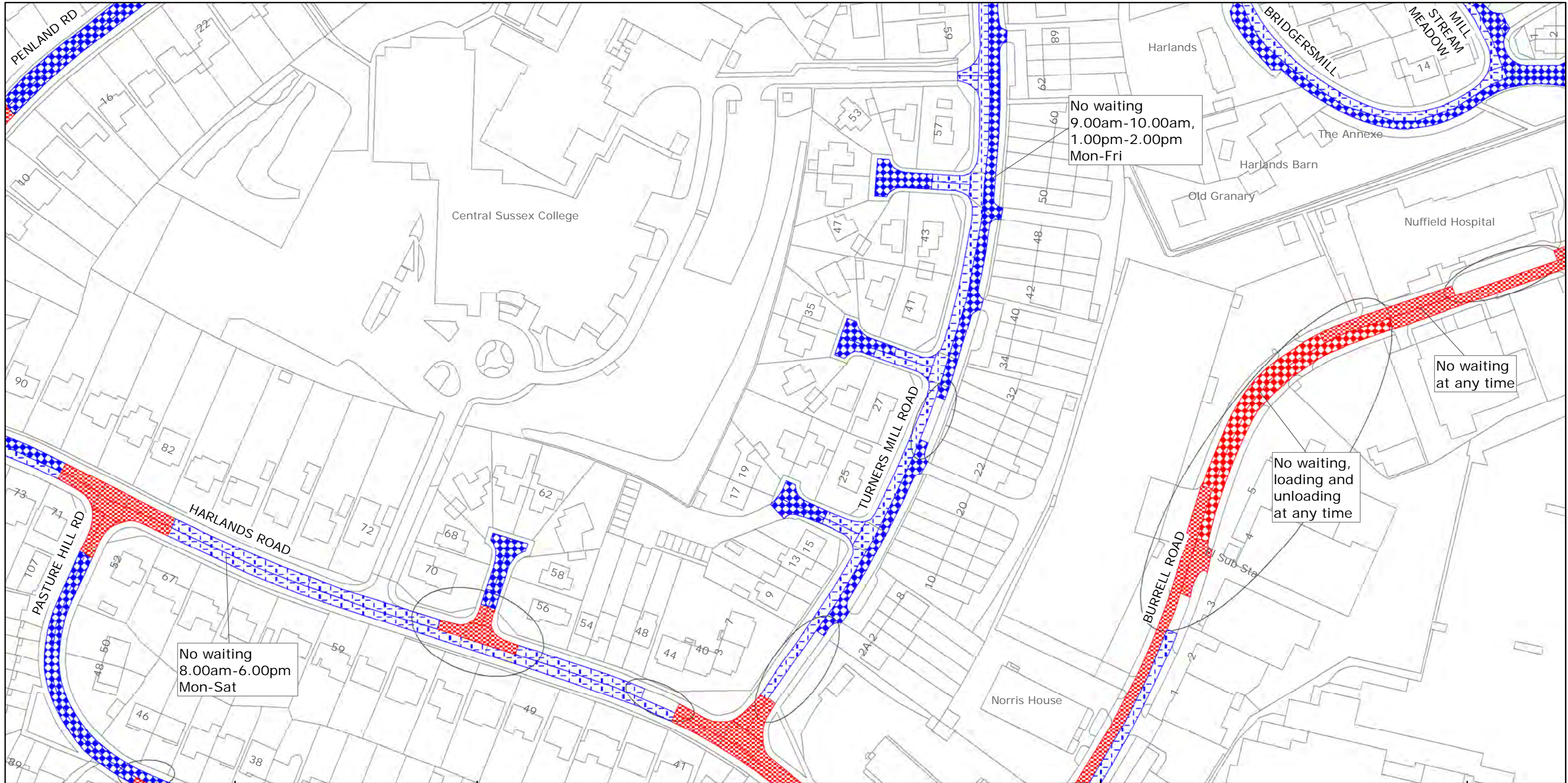

No waiting
9.00am-10.00am,
1.00pm-2.00pm
Mon-Fri

No waiting
8.00am-6.00pm
Mon-Sat

No waiting
at any time

No waiting,
loading and
unloading
at any time



West Sussex County Council
Highways & Transport
The Grange
Tower Street
Chichester
West Sussex
PO19 1RH

MID SUSSEX DISTRICT: HAYWARDS HEATH
PROPOSED WAITING RESTRICTIONS (09.06.2017)

TILE REF NO:
TQ3224NEN

SHEET ISSUE NO 5_CMS1405
SHEET ACTIVE FROM - DD/MM/YYYY



SCALE:
1:1250
at A3 size

Reproduced from or based upon 2017 Ordnance Survey mapping with permission of the Controller of HMSO (c) Crown Copyright reserved.
Unauthorised reproduction infringes Crown copyright and may lead to prosecution or civil proceedings West Sussex County Council Licence No. 100018485

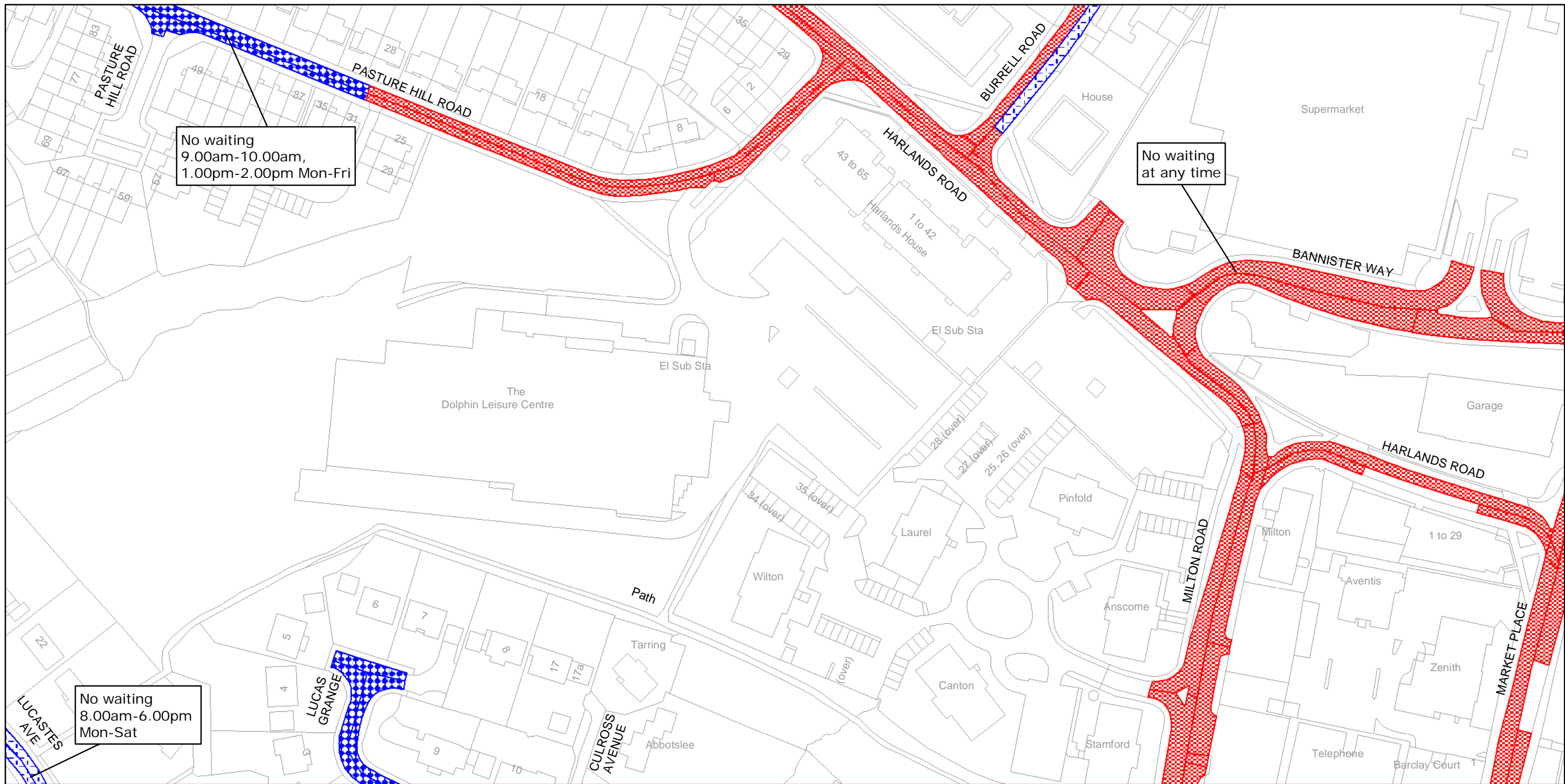

No waiting
9.00am-10.00am,
1.00pm-2.00pm Mon-Fri

No waiting
at any time

No waiting
8.00am-6.00pm
Mon-Sat



West Sussex County Council
Highways & Transport
The Grange
Tower Street
Chichester
West Sussex
PO19 1RH

MID SUSSEX DISTRICT: HAYWARDS HEATH
WAITING RESTRICTIONS

TILE REF NO:
TQ3224NES

SHEET ISSUE NO 3
SHEET ACTIVE FROM - 23/08/2006

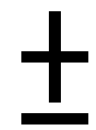

SCALE:
1:1250
at A3 size

Reproduced from or based upon 2006 Ordnance Survey mapping with permission of the Controller of HMSO (c) Crown Copyright reserved.
Unauthorised reproduction infringes Crown copyright and may lead to prosecution or civil proceedings West Sussex County Council Licence No. 100018485

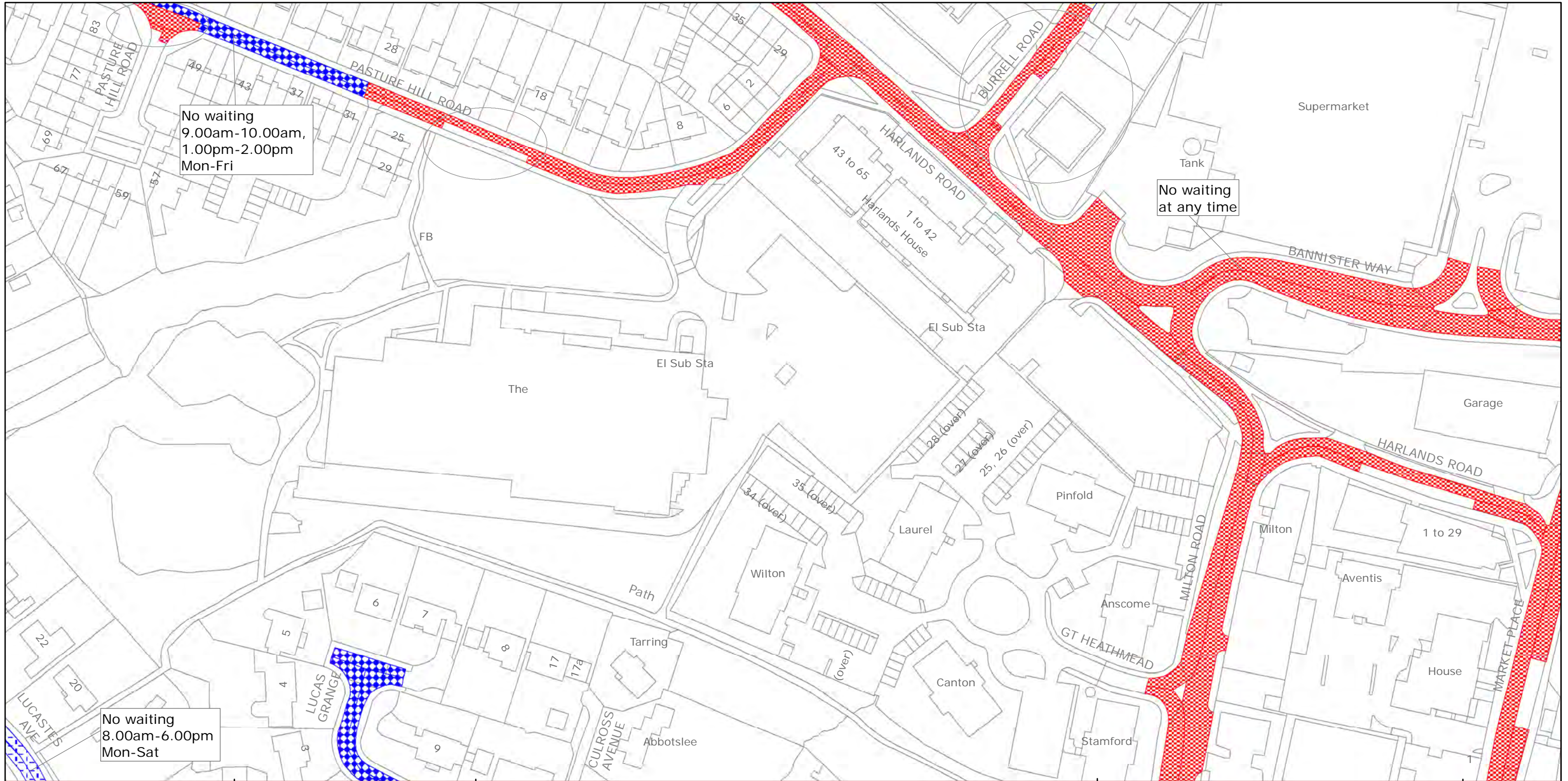

No waiting
9.00am-10.00am,
1.00pm-2.00pm
Mon-Fri

No waiting
at any time

No waiting
8.00am-6.00pm
Mon-Sat



West Sussex County Council
Highways & Transport
The Grange
Tower Street
Chichester
West Sussex
PO19 1RH

MID SUSSEX DISTRICT: HAYWARDS HEATH
PROPOSED WAITING RESTRICTIONS (09.01.2017)

TILE REF NO:
TQ3224NES

SHEET ISSUE NO 4_CMS1405
SHEET ACTIVE FROM - DD/MM/YYYY



SCALE:
1:1250
at A3 size

Reproduced from or based upon 2017 Ordnance Survey mapping with permission of the Controller of HMSO (c) Crown Copyright reserved.
Unauthorised reproduction infringes Crown copyright and may lead to prosecution or civil proceedings West Sussex County Council Licence No. 100018485



West Sussex County Council
 Highways & Transport
 The Grange
 Tower Street
 Chichester
 West Sussex
 PO19 1RH

MID SUSSEX DISTRICT: HAYWARDS HEATH
 NO EXISTING WAITING RESTRICTIONS

TILE REF NO:
 TQ3225NES

SHEET ISSUE NO
 SHEET ACTIVE FROM - DD/MM/YYYY at A3 size



SCALE:
 1:1250

Reproduced from or based upon 2013 Ordnance Survey material with permission of the Controller of HMSO (c) Crown Copyright reserved.
 Unauthorised reproduction infringes Crown copyright and may lead to prosecution or civil proceedings West Sussex County Council Licence No. 100023447

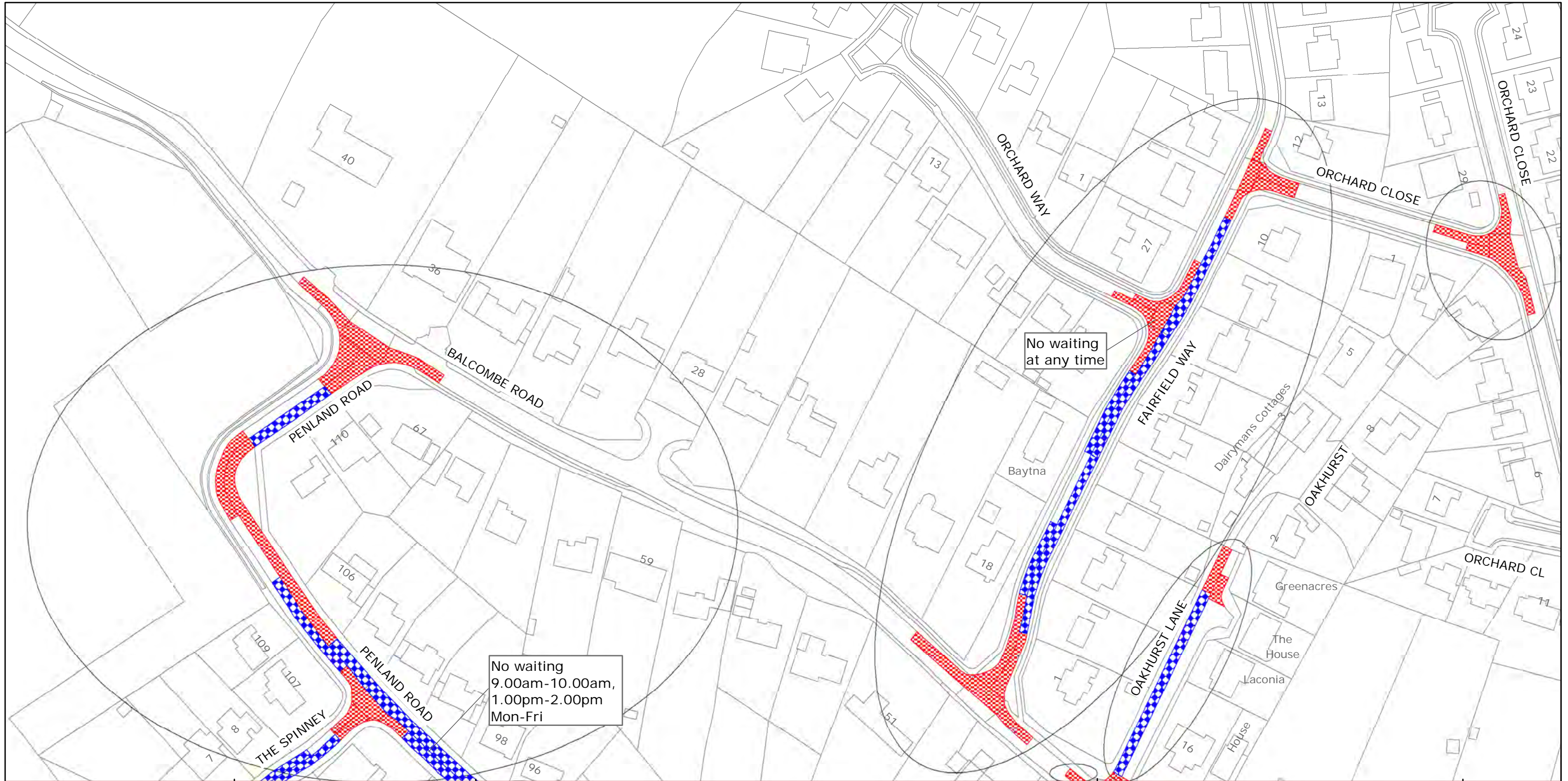

West Sussex County Council
 Highways & Transport
 The Grange
 Tower Street
 Chichester
 West Sussex
 PO19 1RH

MID SUSSEX DISTRICT: HAYWARDS HEATH
 PROPOSED WAITING RESTRICTIONS (30.05.2017)

TILE REF NO:
 TQ3225NES

SHEET ISSUE NO 1_CMS1405
 SHEET ACTIVE FROM - DD/MM/YYYY



SCALE:
 1:1250
 at A3 size

Reproduced from or based upon 2017 Ordnance Survey mapping with permission of the Controller of HMSO (c) Crown Copyright reserved.
 Unauthorised reproduction infringes Crown copyright and may lead to prosecution or civil proceedings West Sussex County Council Licence No. 100018485

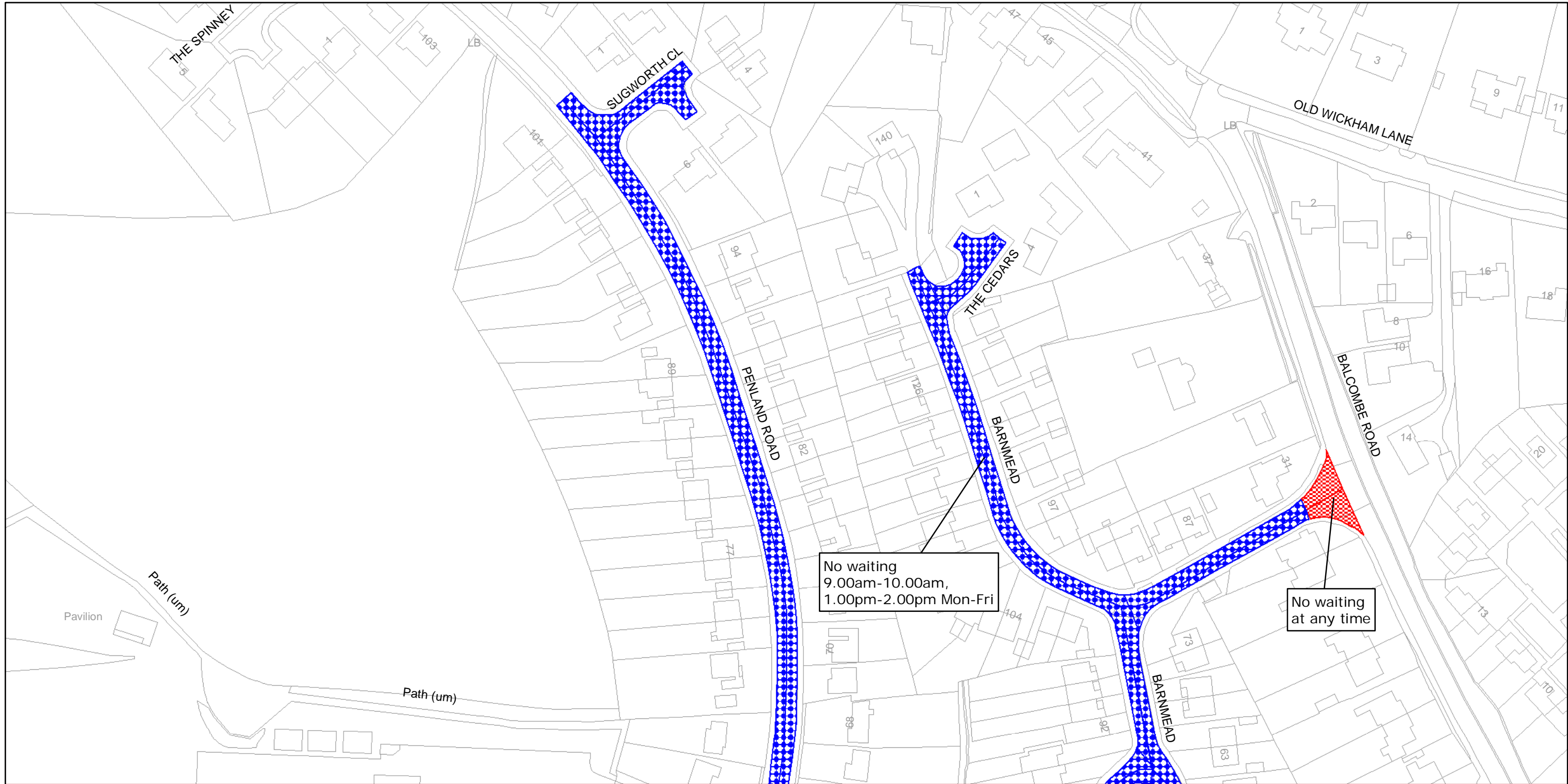

West Sussex County Council
 Highways & Transport
 The Grange
 Tower Street
 Chichester
 West Sussex
 PO19 1RH

MID SUSSEX DISTRICT: HAYWARDS HEATH
 WAITING RESTRICTIONS

TILE REF NO:
 TQ3225SEN

SHEET ISSUE NO 3
 SHEET ACTIVE FROM - 23/08/2006

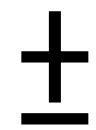

SCALE:
 1:1250
 at A3 size

Reproduced from or based upon 2006 Ordnance Survey mapping with permission of the Controller of HMSO (c) Crown Copyright reserved. Unauthorised reproduction infringes Crown copyright and may lead to prosecution or civil proceedings West Sussex County Council Licence No. 100018485

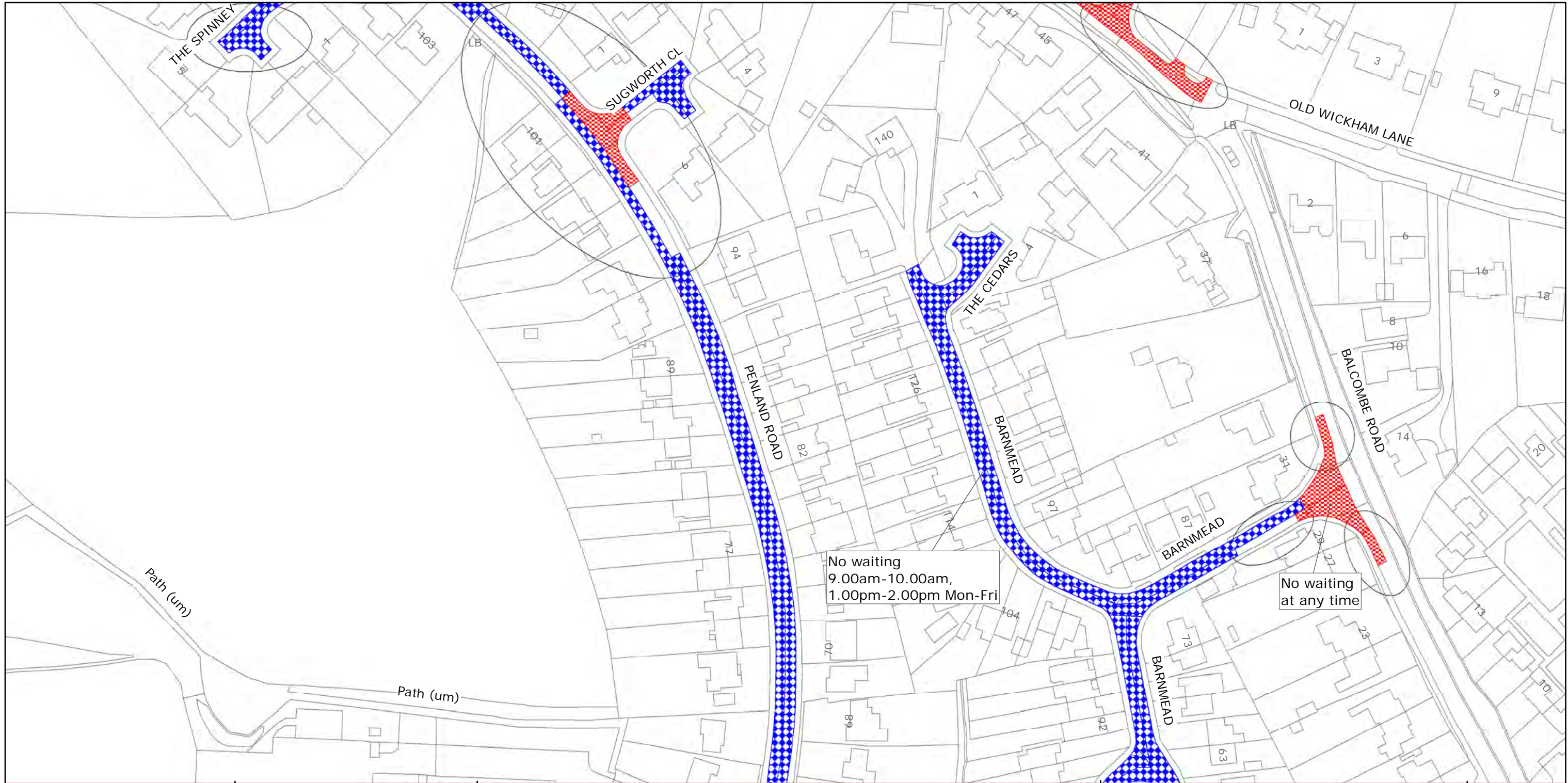

West Sussex County Council
 Highways & Transport
 The Grange
 Tower Street
 Chichester
 West Sussex
 PO19 1RH

MID SUSSEX DISTRICT: HAYWARDS HEATH
 PROPOSED WAITING RESTRICTIONS (15.04.2016)

TILE REF NO:
 TQ3225SEN

SHEET ISSUE NO 4_CMS1405
 SHEET ACTIVE FROM - DD/MM/YYYY



SCALE:
 1:1250
 at A3 size

Reproduced from or based upon 2017 Ordnance Survey mapping with permission of the Controller of HMSO (c) Crown Copyright reserved.
 Unauthorised reproduction infringes Crown copyright and may lead to prosecution or civil proceedings West Sussex County Council Licence No. 100018485

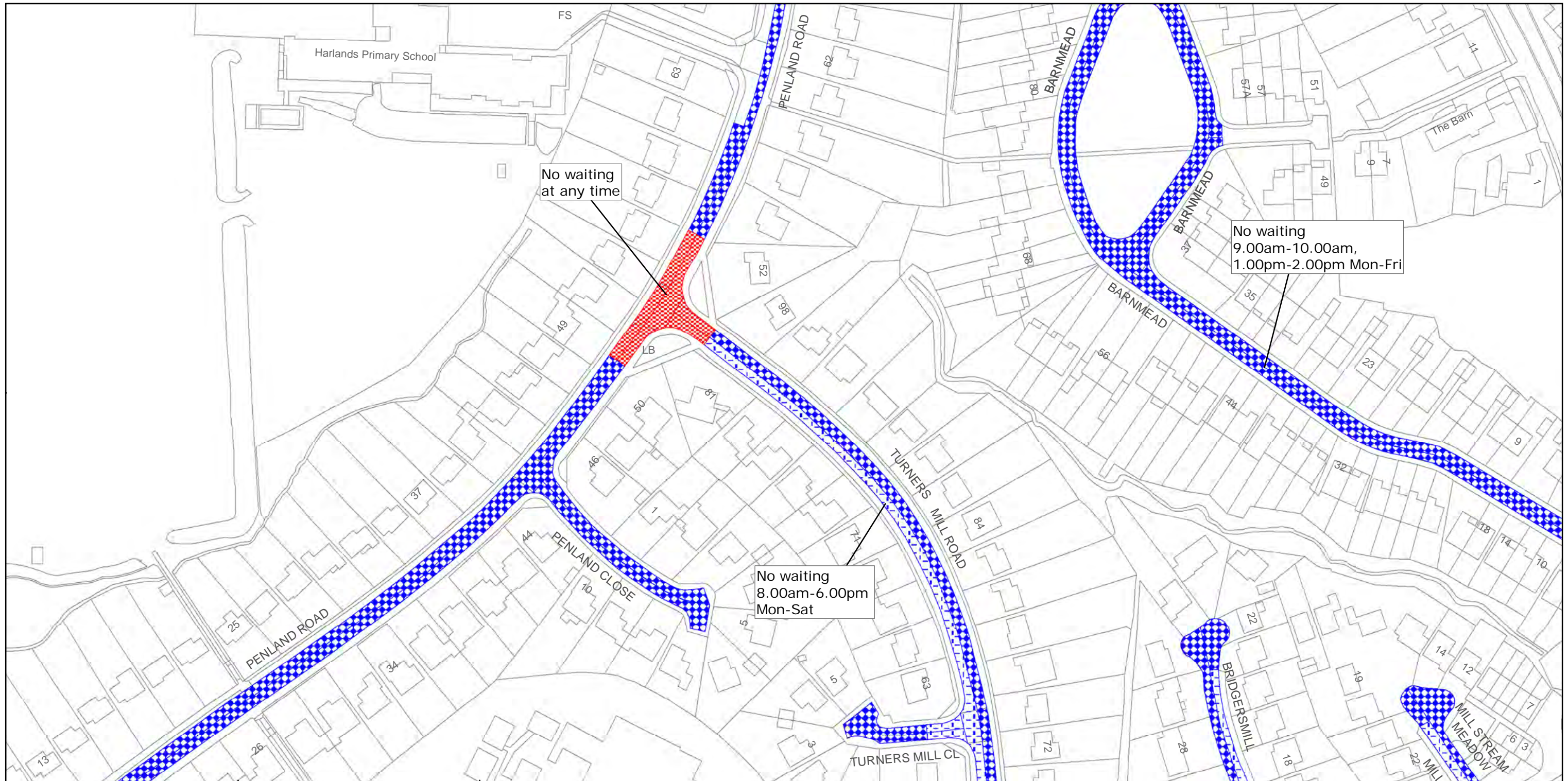

West Sussex County Council
 Highways & Transport
 The Grange
 Tower Street
 Chichester
 West Sussex
 PO19 1RH

MID SUSSEX DISTRICT: HAYWARDS HEATH
 WAITING RESTRICTIONS

TILE REF NO:
 TQ3225SES

SHEET ISSUE NO 4
 SHEET ACTIVE FROM - 12/10/2015



SCALE:
 1:1250
 at A3 size

Reproduced from or based upon 2013 Ordnance Survey material with permission of the Controller of HMSO (c) Crown Copyright reserved.
 Unauthorised reproduction infringes Crown copyright and may lead to prosecution or civil proceedings West Sussex County Council Licence No. 100023447

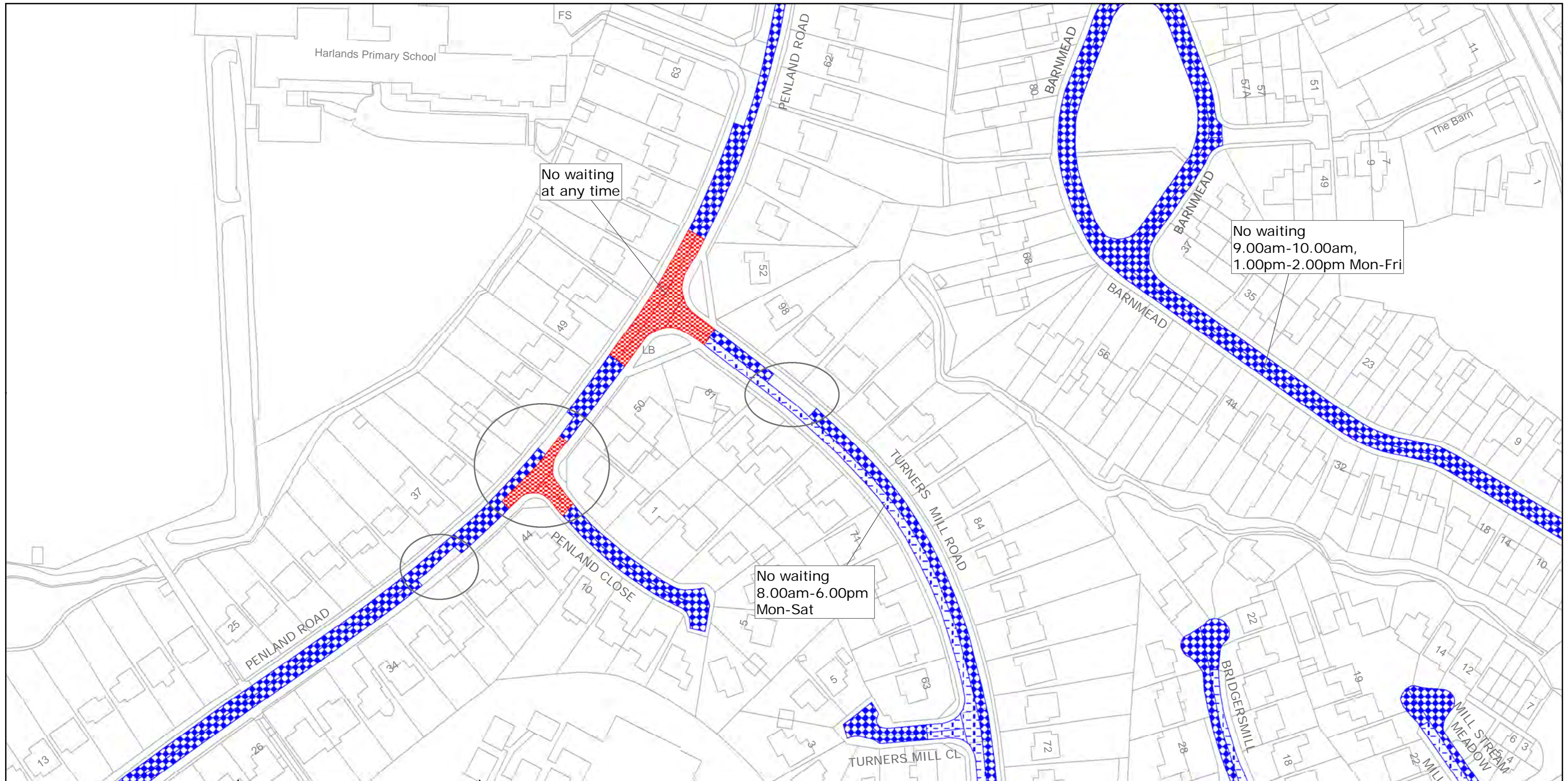

West Sussex County Council
 Highways & Transport
 The Grange
 Tower Street
 Chichester
 West Sussex
 PO19 1RH

MID SUSSEX DISTRICT: HAYWARDS HEATH
 PROPOSED WAITING RESTRICTIONS (15.04.2016)

TILE REF NO:
 TQ3225SES

SHEET ISSUE NO 5_CMS1405
 SHEET ACTIVE FROM - DD/MM/YYYY at A3 size



SCALE:
 1:1250

Reproduced from or based upon 2013 Ordnance Survey material with permission of the Controller of HMSO (c) Crown Copyright reserved.
 Unauthorised reproduction infringes Crown copyright and may lead to prosecution or civil proceedings West Sussex County Council Licence No. 100023447

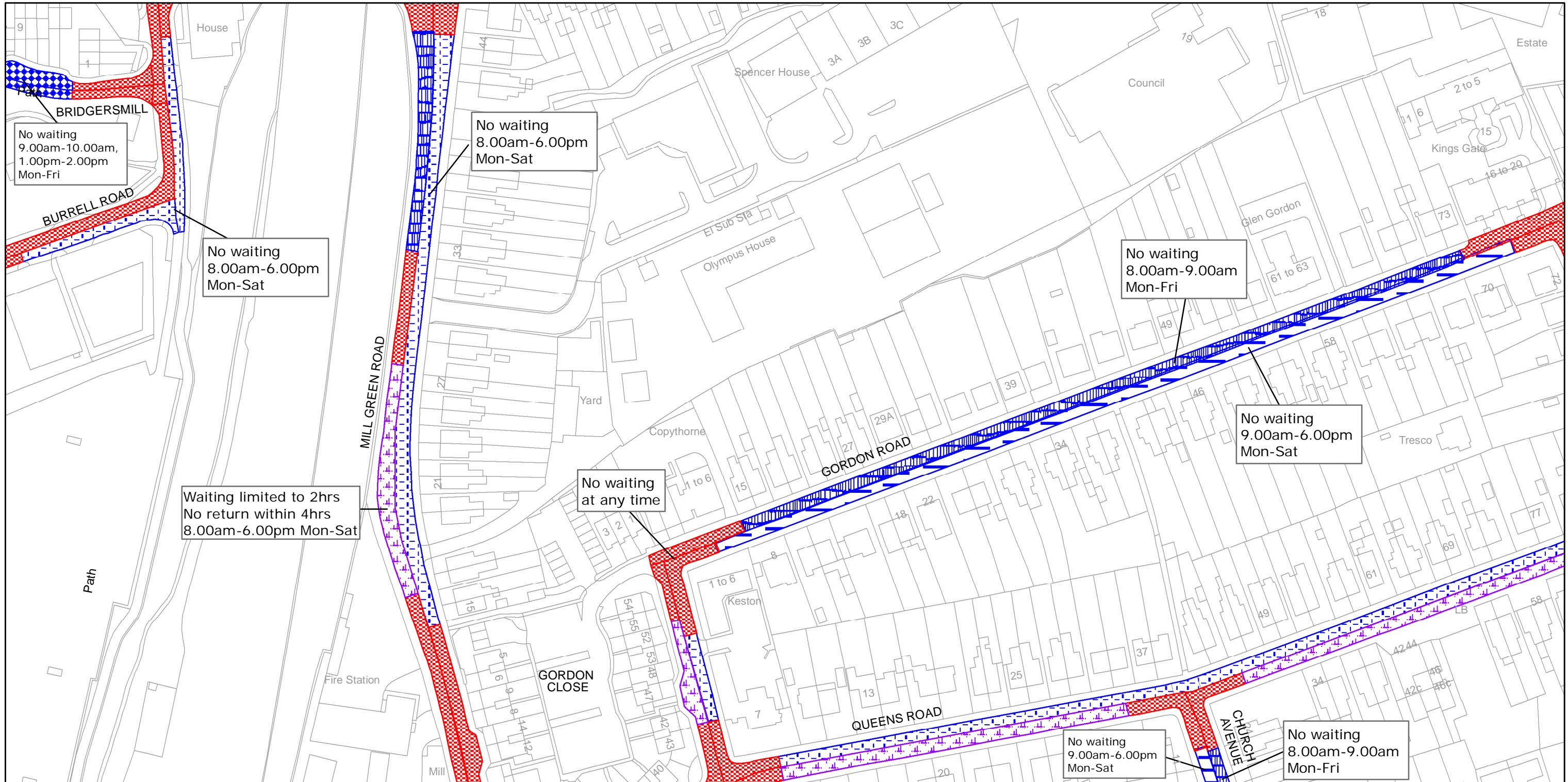

West Sussex County Council
 Infrastructure
 The Grange
 Tower Street
 Chichester
 West Sussex
 PO19 1RH

MID SUSSEX DISTRICT: HAYWARDS HEATH
 WAITING RESTRICTIONS

Reproduced from or based upon 2009 Ordnance Survey mapping with permission of the Controller of HMSO (c) Crown Copyright reserved.
 Unauthorised reproduction infringes Crown copyright and may lead to prosecution or civil proceedings West Sussex County Council Licence No. 100023447

TILE REF NO:
 TQ3324NWN

SHEET ISSUE NO 4
 SHEET ACTIVE FROM - 26/04/2010 at A3 size



SCALE:
 1:1250

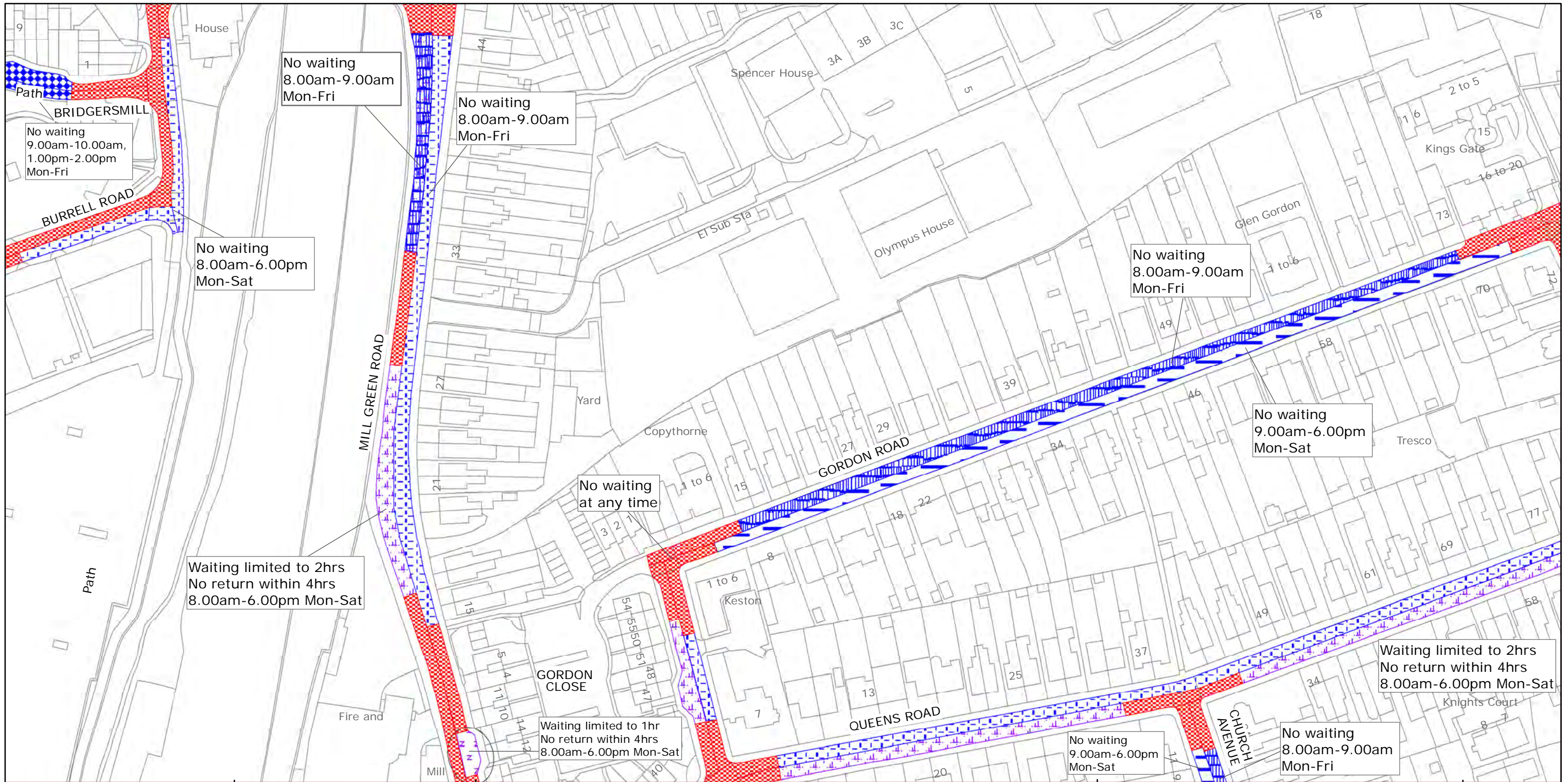

West Sussex County Council
 Highways & Transport
 The Grange
 Tower Street
 Chichester
 West Sussex
 PO19 1RH

MID SUSSEX DISTRICT: HAYWARDS HEATH
 PROPOSED WAITING RESTRICTIONS (11.05.2017)

Reproduced from or based upon 2017 Ordnance Survey mapping with permission of the Controller of HMSO (c) Crown Copyright reserved.
 Unauthorised reproduction infringes Crown copyright and may lead to prosecution or civil proceedings West Sussex County Council Licence No. 100018485

TILE REF NO:
 TQ3324NWN

SHEET ISSUE NO 5_CMS1405
 SHEET ACTIVE FROM - DD/MM/YYYY



SCALE:
 1:1250
 at A3 size

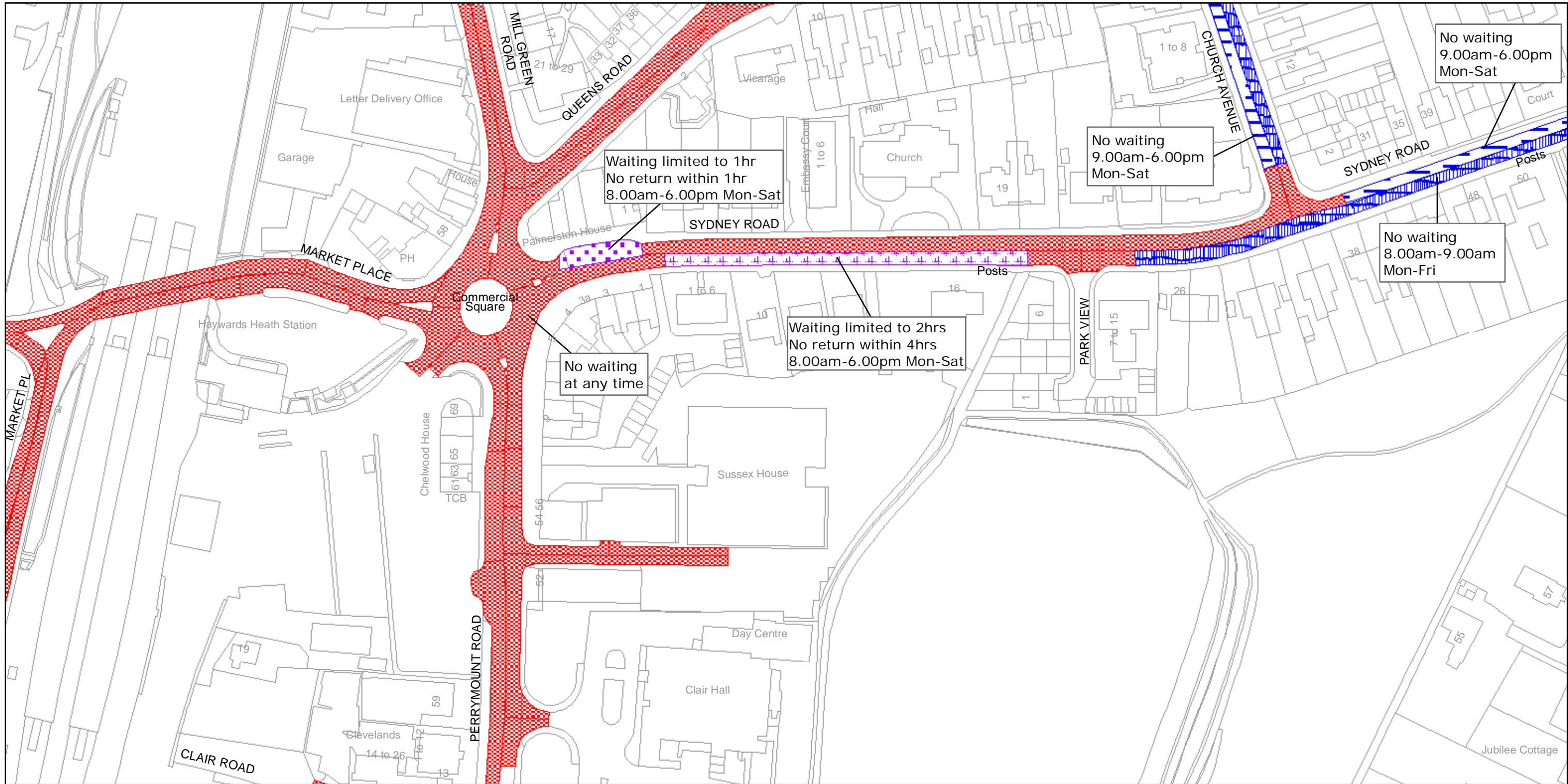

West Sussex County Council
 Infrastructure
 The Grange
 Tower Street
 Chichester
 West Sussex
 PO19 1RH

MID SUSSEX DISTRICT: HAYWARDS HEATH
 WAITING RESTRICTIONS

TILE REF NO:
 TQ3324NWS

SHEET ISSUE NO 4
 SHEET ACTIVE FROM - 26/04/2010

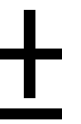

SCALE:
 1:1250
 at A3 size

Reproduced from or based upon 2009 Ordnance Survey mapping with permission of the Controller of HMSO (c) Crown Copyright reserved.
 Unauthorised reproduction infringes Crown copyright and may lead to prosecution or civil proceedings West Sussex County Council Licence No. 100023447

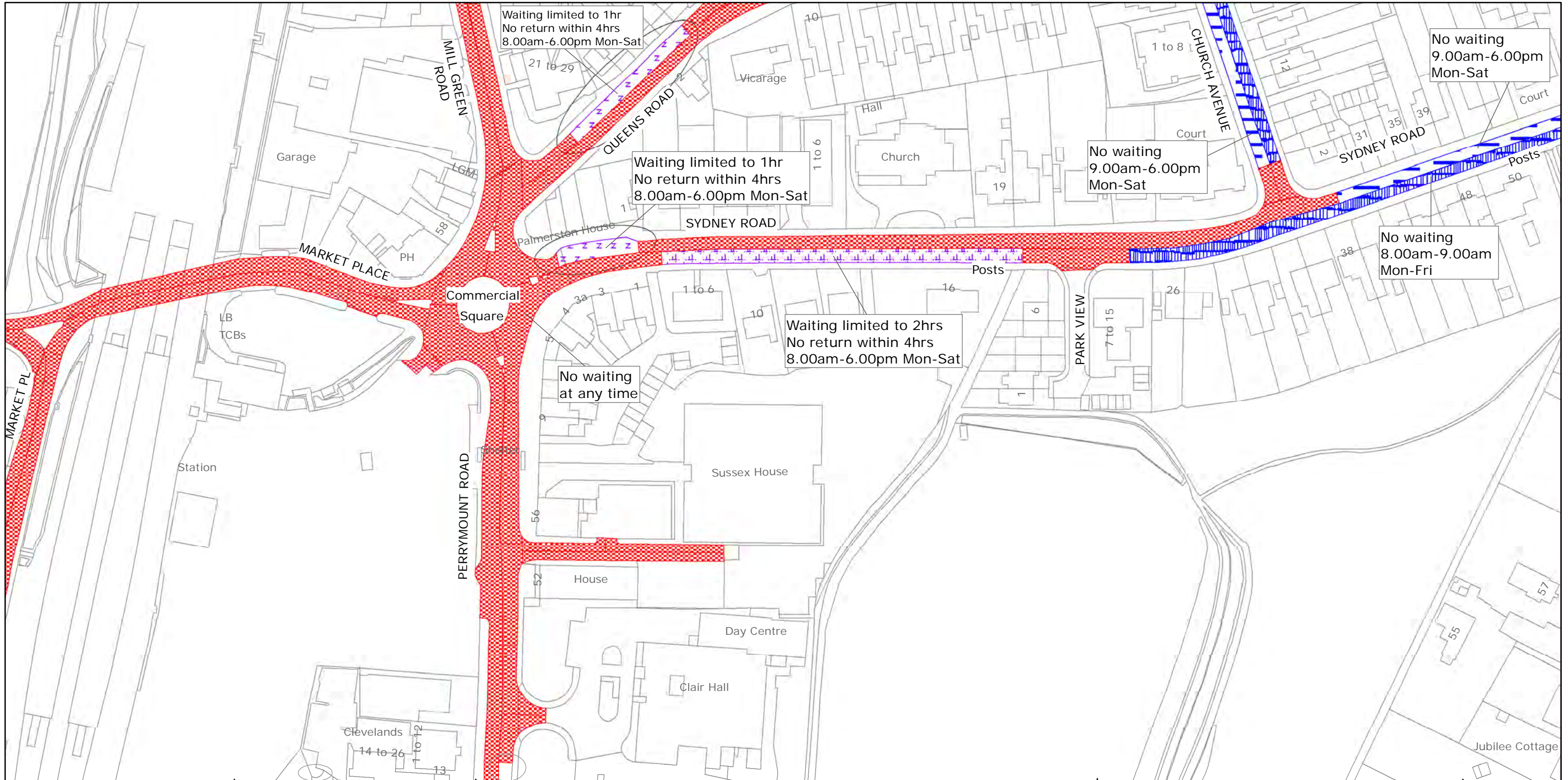

West Sussex County Council
 Highways & Transport
 The Grange
 Tower Street
 Chichester
 West Sussex
 PO19 1RH

MID SUSSEX DISTRICT: HAYWARDS HEATH
 PROPOSED WAITING RESTRICTIONS (11.05.2017)

Reproduced from or based upon 2017 Ordnance Survey mapping with permission of the Controller of HMSO (c) Crown Copyright reserved.
 Unauthorised reproduction infringes Crown copyright and may lead to prosecution or civil proceedings West Sussex County Council Licence No. 100018485

TILE REF NO:
 TQ3324NWS

SHEET ISSUE NO 5_CMS1405
 SHEET ACTIVE FROM - DD/MM/YYYY



SCALE:
 1:1250
 at A3 size